

Purdie & Swan

Lettings and Property Management



Barnes Close, Winchester
Price: £1,500 PCM



STORAGE ROOM * GARAGE * TOP FLOOR FLAT * SPACIOUS
PROPERTY * ST CROSS AREA * COMMUNAL GARDENS *
VIEWING HIGHLY RECOMMENDED * NEUTRALLY DECORATED
* PHOTOGRAPHS FROM 2020.

A particularly spacious flat in the heart of the popular area of St Cross which has been finished to an exceptionally high standard and has the added benefit of a garage and a storage room. St Cross is within easy access of the city centre, railway station and the M3 and its onward links. The flat is situated on the top floor and has been finished in a contemporary style and comprises, kitchen which includes freestanding fridge/freezer, plumbing for washing machine and dishwasher, oven, hob and extractor over, hall with storage cupboard, spacious reception room with wood effect floors, large principal bedroom, second double bedroom and shower room with double shower cubicle. Downstairs there is internal access to a garage and a secure storage room. The property also benefits from use of the communal gardens and on street permit parking can be obtained via the council for two resident permits and two visitor permits at the tenant's cost. Gas central heating and hot water and all services are mains connected.

Postcode: SO23 9TS

Available: Now

Winchester City Council: Tax band D

EPC Rating: C

Unfurnished

No pets

Deposit: £1730 (five weeks based on advertised rent)

Holding deposit: £346 (one week based on advertised rent)

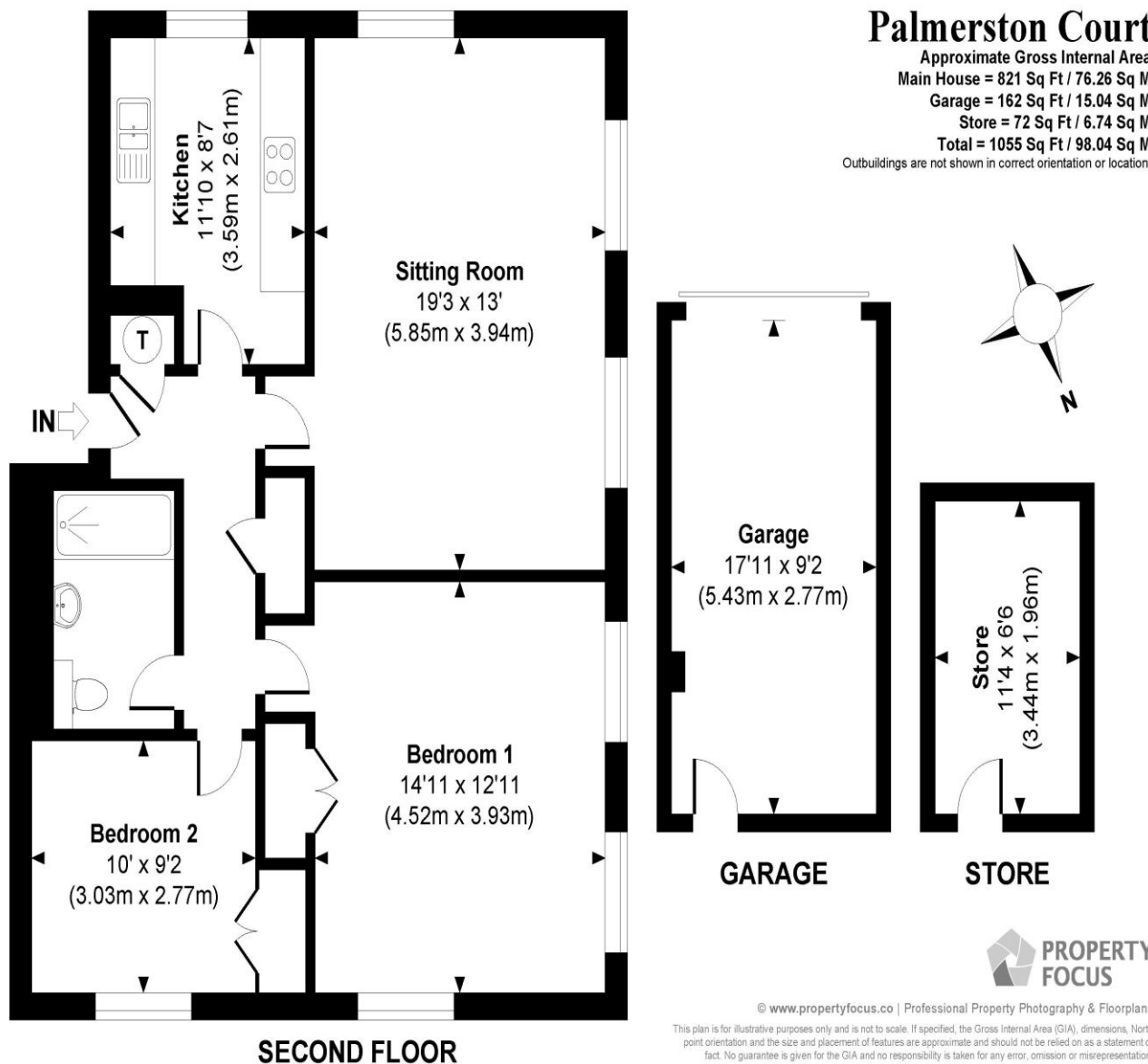

AGENTS DETAILS

T - 01962 842155

E - katherine@purdieandswan.co.uk

W - www.purdieandswan.co.uk

We wish to inform you that these particulars, which are believed to be accurate, are set out for your guidance only, and do not constitute or form part of an offer or contract. You should satisfy yourself by inspection, searches, enquiries and survey as to the correctness of each statement. All statements in these particulars are made without responsibility on the part of Purdie & Swan or the vendor or lessor. All measurements, distances and the proportions of the floor plans provided are approximate. We have not carried out a survey nor tested the services, appliances and specific fittings. Fixtures, fittings and furnishings are not included unless specifically described. It should not be assumed that the property remains as shown in the photographs. Amounts quoted are exclusive of VAT if applicable.